

**AS-BUILT REPORT
INDIVIDUAL SEWAGE TREATMENT SYSTEM**

Legal Description or Complete Street Address		City of Township		
Owner Name	Mail Address	City	State	Zip
Muehrcke	8282 Hidden Bay Court	LAKE ELMO	MIN	55042
Installer	Mail Address	City	State	Zip
Outdoor Design Inc.	2015 Gateway Circle	Hugo	MIN	55038
Septic Tank Information Tank Manufacturer:		Liquid Capacity		
Knife Edge Precast		2 x 1000 gallons each.		

PUMP CHAMBER (if installed)			
Tank Manufacturer:	Liquid Capacity:	Horsepower of Pump:	Type of Warning Device:
Knife Edge	1000 gallons	1 1/2 H.P. Liberty 283-2	Alderon
Pump Discharge in Gallons Per Minute:	at	Feet of	Number of Gallons Per Cycle:
42 GPM	at	15' head	136

DRAINFIELD TRENCH		BED OR MOUND	
Width:	Length of Each Trench:	Rock Bed Length:	Width: Area:
			60' x 10' = 600 sq. ft.
Depth of Trench Bottom from Finished Grade:	N/A	Bed Depth from Grade:	N/A
Method of Distribution:	<input type="checkbox"/> Pressure <input type="checkbox"/> Distribution Box <input type="checkbox"/> Drop Box	MOUND:	Upslope Sand Base Depth: Downslope Sand Base Depth:
			12" 20"
Depth of Rock Under Distribution Pipe:		Depth of Rock Under Pipe:	
			9"
Square Footage of Tested Area Used:	PRESSURE DISTRIBUTION SYSTEM:		
Trench Bottom Square Footage Required:	Area As Built:	Lateral Inside Diameter:	Length: Perforation Size:
		2"	29 1/4"
		Spacing: Number: Perforation Spacing:	
		36" 6 36"	

Complete site plan on attached sheet. On the site plan, include location of the following items.

Structures, septic tank, pump chamber, line from house to tank treatment system, distribution lines, distribution or drop boxes, well, and driveway. Show all distances applicable to the sewage treatment system (distance from structure to tank, tank to treatment system, distance between distribution lines, length of distribution lines, and distance between well and sewage treatment system). Indicate NORTH on the site plan and the sale of the plan.

I hereby certify that the system at the above referenced address was installed according to the Individual Sewage Treatment System Ordinance requirements.

Signed: Tom Powers MPCA License #: 136981464 Dated: 11/20/09

SEPTIC PERMIT NUMBER LAKE ELMO 7244



Property Line

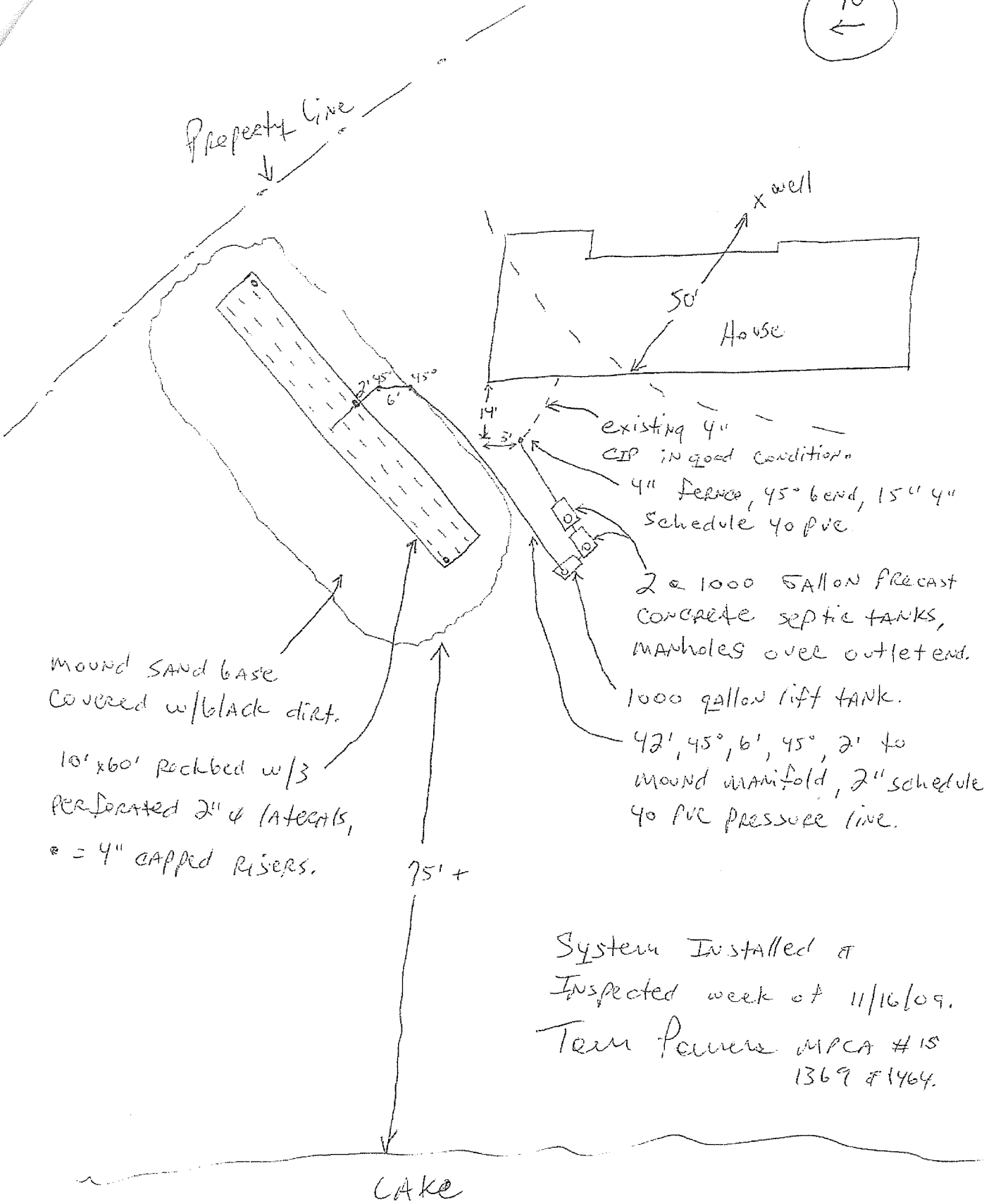

mound sand base
covered w/black dirt.

10' x 60' rockbed w/3
perforated 2" laterals,
• = 4" capped risers.

75' +

existing 4" CIP in good condition

4" ferroc, 45° bend, 15" 4" schedule 40 pvc.

2 x 1000 gallon precast concrete septic tanks, manholes over outlet end.

1000 gallon lift tank.

42', 45°, 6', 45°, 2" to mound manifold, 2" schedule 40 pvc pressure line.

System Installed &
Inspected week of 11/16/09.
Tom Powers MPCA #15
1369 & 1464.

Lake